

## TEST ITEMS

| Cat. #                                 | Test items    | Cut-OFF value  | Sample types | Measuring range                                 | Sample volume | Reaction time |
|--|---------------|--|--------------|---|---------------|---------------|
| <b>Reproduction/ Fertility</b>         |               |  |              |   |               |               |
| DCR2066                                | Testosterone  | Male: 1.75-7.81 ng/mL<br>Female: 0.10-0.75 ng/mL       | S/P          | 0.10-16.00 ng/mL                                | 100 µL        | 15 min        |
| DCR2068                                | Estradiol     | Refer to user manual                                   | S/P          | 40.0-4800.0 pg/mL                               | 100 µL        | 15 min        |
| <b>Tumor Markers</b>                   |               |  |              |   |               |               |
| DCR2018                                | tPSA          | 4.00 ng/mL   | S/P          | 0.50-100.00 ng/mL                               | 100 µL        | 15 min        |
| DCR2090                                | fPSA          | 1.00 ng/mL   | S/P          | 0.05-30.00 ng/mL                                | 100 µL        | 10 min        |
| DCR2029                                | AFP           | 7.0 ng/mL  | S/P          | 2.0-500.0 ng/mL                                 | 100 µL        | 15 min        |
| DCR2032                                | CEA           | 4.7 ng/mL  | S/P          | 2.0-500.0 ng/mL                                 | 100 µL        | 15 min        |
| DCR2086                                | PG I/PG II    | PG I < 70.0 ng/mL<br>PG I/ PG II < 3.0 ng/mL           | S/P          | PG I: 1.0-200.0 ng/mL<br>PG II: 1.0-100.0 ng/mL | 100 µL        | 15 min        |
| DCR2087                                | CA125         | 35.0 U/mL  | S/P/WB       | 2-500.0 U/mL                                    | 100 µL        | 15 min        |
| DCR2088                                | CA199         | 27.0 U/mL  | S/P/WB       | 2-1000.0 U/mL                                   | 100 µL        | 15 min        |
| DCR2089                                | CA15-3        | 26.2 U/mL  | S/P/WB       | 1.5-300.0 U/mL                                  | 100 µL        | 15 min        |
| <b>Infectious Diseases</b>             |               |  |              |   |               |               |
| DCR2083                                | Anti-HCV      | 1.00 S/CO  | S/P          | 1.00-20.00 S/CO                                 | 100 µL        | 15 min        |
| DCR2034                                | Anti-TP       | 1.00 S/CO  | S/P          | 1.00-50.00 S/CO                                 | 100 µL        | 15 min        |
| DCR2084                                | Anti-HIV      | 1.00 S/CO  | S/P          | 1.00-1000.00 S/CO                               | 100 µL        | 15 min        |
| DCR2081                                | HBsAg         | 1.00 IU/mL   | S/P          | 1.00-100.00 IU/mL                               | 100 µL        | 15 min        |
| DCR2082                                | Anti-HBs      | 10.00 mIU/mL   | S/P/WB       | 10.00-1000.00 mIU/mL                            | 100 µL        | 15 min        |
| DCR2038                                | H.pylori      | 5.0 ng/mL  | Stool        | 1.0-200.0 ng/mL                                 | 100 µL        | 10 min        |
| DCR2054                                | Influenza A/B | 1.00 COI   | Nasal swab   |   | 100 µL        | 15 min        |
| DCR2075                                | Dengue NS1 Ag | 1.00 S/CO  | S/P/WB       | 1.00-50.00S/CO                                  | 100 µL        | 15 min        |
| <b>Specific Protein and Rheumatism</b> |               |  |              |   |               |               |
| DCR2078                                | RF            | 15.9 IU/mL   | S/P/WB       | 10.0-640.0 IU/mL                                | 10 µL         | 10 min        |
| DCR2056                                | ASO           | 408.0 IU/mL  | S/P/WB       | 60.0-1370.0 IU/mL                               | 10 µL         | 10 min        |
| DCR2053                                | Anti-CCP      | 25.0 U/mL  | S/P/WB       | 10.0-400.0 U/mL                                 | 10 µL         | 15 min        |
| <b>Others</b>                          |               |  |              |   |               |               |
| DCR2030                                | Ferritin      | Male: 30.00-400.00 ng/mL<br>Female: 13.00-150.00 ng/mL | S/P          | 0.50-1000.00 ng/mL                              | 10 µL         | 15 min        |
| DCR2040                                | Total IgE     | Refer to user Manual                                   | S/P/WB       | 1.00-2000.00 IU/mL                              | 100 µL        | 15 min        |
| DCR2067                                | Cortisol      | Refer to user Manual                                   | S/P          | 11-1655 nmol/L                                  | 100 µL        | 15 min        |



# DCR2000 PLUS

Immunofluorescence Quantitative Analyzer  
Multi Channel System



## QR CODE



www.biozek.com

Cardiac

Coagulation

Diabetes

Inflammation

Hormone

Renal  
Function

Tumor

Infectious  
disease

Fertility

## The analyzer can be widely applied to many clinical departments:

- Oncology Dept.
- Gynaecology Dept.
- Clinical Laboratory
- Nephrology Dept.
- Respiratory Dept.
- Emergency Dept.
- Pediatrics Dept.
- Gastroenterology Dept.
- ICU
- Endocrinology Dept.
- Urology Dept.

## TECHNICAL SPECIFICATIONS



- Large Display**
  - 10.1" LCD touch screen
  - Intuitive user interface
- Built-in Thermal Printer**
  - Real-time auto-printing
  - Support for external printer
- Connectivity**
  - Ethernet port for LIS/HIS COM port for PC
  - 2 USB ports for software update and file copy
- Cases Storage**
  - Over 100,000 test cases
- Android System**
  - Smooth operation
  - Easy operating software updates
- Repeatability**
  - CV ≤ 2% within range [100, 15000] mV
  - CV ≤ 10% within range [0, 100] mV
- Sampling**
  - Sample Type: serum, plasma, whole blood, capillary blood, urine, swab, saliva, stool
  - Sample Volume: 10 ~ 200 µL depending on the assay
- RFID Card Calibration**
  - Automatic reading of batch number and calibration information

## OPERATION PROCEDURE

01

Sample dispense

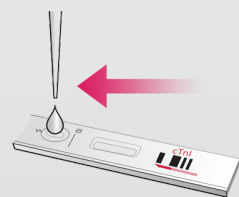

02

Insert test cards, four allowed at the same time



03

Waiting in incubation



## TEST ITEMS

| Cat. #                         | Test items         | Cut-OFF value  | Sample types               | Measuring range  | Sample volume | Reaction time |
|--------------------------------|--------------------|--|----------------------------|--|---------------|---------------|
| <b>Cardiac Markers</b>         |                    |  |                            |  |               |               |
| DCR2001                        | cTnI               | 0.10 ng/mL   | S/P/WB                     | 0.10-50.00 ng/mL   | 100 µL        | 10 min        |
| DCR2055                        | TnT                | 14.0 pg/mL   | S/P/WB                     | 10.0-10000.0 pg/ml                                       | 100 µL        | 15 min        |
| DCR2002                        | NT-proBNP          | 300 pg/mL  | S/P/WB                     | 100-35000 pg/mL  | 100 µL        | 10 min        |
| DCR2005                        | CK-MB/cTnI/Myo     | CK-MB: 5.00 ng/mL<br>cTnI: 0.10 ng/mL<br>Myo: 70.0 ng/mL | S/P/WB                     | 2.50-80.00 ng/mL<br>0.10-50.00 ng/mL<br>30.0-600.0 mg/mL | 100 µL        | 10 min        |
| DCR2020                        | H-FABP             | 6.36 ng/mL   | S/P/WB                     | 1.00-120.00 ng/mL  | 100 µL        | 3 min         |
| DCR2022                        | CK-MB              | 5.00 ng/mL   | S/P/WB                     | 2.50-80.00 ng/mL   | 100 µL        | 10 min        |
| DCR2043                        | ST2                | 35.0 mg/mL   | S/P/WB                     | 3.0-200.0 ng/mL  | 100 µL        | 15 min        |
| <b>Coagulation markers</b>     |                    |  |                            |  |               |               |
| DCR2006                        | D-dimer            | 0.50 mg/L  | P/WB                       | 0.10-10.00 ng/mL   | 100 µL        | 10 min        |
| <b>Inflammation</b>            |                    |  |                            |  |               |               |
| DCR2003                        | Hs-CRP+CRP         | 3.0 mg/L   | S/P/WB<br>Fingertip blood  | 0.5-2000.0 mg/L  | 10 µL         | 3 min         |
| DCR2007                        | PCT                | 0.10 ng/mL   | S/P/WB                     | 0.05-50.00 ng/ mL  | 100 µL        | 15 min        |
| DCR2024                        | SAA                | 10.0 mg/L  | S/P/WB<br>Fingertip blood  | 5.0-200.0 mg/L   | 10 µL         | 5 min         |
| DCR2047                        | IL-6               | 7.0 pg/mL  | S/P/WB<br>Peripheral blood | 1.5-400.0 pg/mL  | 40 µL         | 15 min        |
| <b>Renal Function</b>          |                    |  |                            |  |               |               |
| DCR2008                        | CysC               | 0.51-1.09 mg/L   | S/P/WB                     | 0.50-10 mg/ L  | 10 µL         | 3 min         |
| DCR2009                        | mAlb               | 20.0 mg/L  | Urine                      | 10.0-200.0 mg/L  | 100 µL        | 3 min         |
| DCR2010                        | NGAL               | Serum: 200.0 ng mL<br>Urine: 100.0 ng/ml                 | S/Urine                    | 50.0-5000.0 ng/ml  | 10 µL         | 10 min        |
| DCR2011                        | β <sub>2</sub> -MG | 0.80-3.00 mg/L   | S/P/WB                     | 0.50-20.00 mg/L  | 10 µL         | 3min          |
| <b>Diabetes Mellitus</b>       |                    |  |                            |  |               |               |
| DCR2012                        | HbA1c              | 3.80%-5.80%  | WB                         | 2.00%-14.00%   | 10 µL         | 5 min         |
| <b>Metabolic Marker</b>        |                    |  |                            |  |               |               |
| DCR2016                        | 25-OH-VD           | 30.00-50.00 ng/mL  | S/P/WB<br>Capillary blood  | 8.00-70.00 ng/mL   | 30 µL         | 30 min        |
| DCR2085                        | Osteocalcin        | Male:14-70 ng/mL<br>Female: 11-48 ng/mL                  | S/P/WB                     | 1.5-300.0 ng/mL  | 100 µL        | 15 min        |
| <b>Thyroid Function</b>        |                    |  |                            |  |               |               |
| DCR2013                        | TSH                | 0.27-4.20 µIU/mL   | S/P                        | 0.10-50.00 µIU/mL  | 100 µL        | 15 min        |
| DCR2014                        | T3                 | 1.30-3.10 nmol/L   | S/P                        | 0.30-10.00 nmol/L  | 100 µL        | 15 min        |
| DCR2015                        | T4                 | 59.00-154.00 nmol/L                                      | S/P                        | 5.40-320.00 nmol/L                                       | 100 µL        | 15 min        |
| DCR2049                        | FT3                | 3.10-6.80 pmol/L   | S/P/WB                     | 0.60-50.00 pmol/L  | 100 µL        | 15 min        |
| DCR2045                        | FT4                | 12.00-2200 pmol/L  | S/P/WB                     | 0.30-100.00 pmol/L                                       | 100 µL        | 15 min        |
| <b>Reproduction/ Fertility</b> |                    |  |                            |  |               |               |
| DCR2017                        | HCG+ β             | 5.1 mIU/mL   | S/P                        | 5.0-100000.0 mIU/mL                                      | 100 µL        | 10 min        |
| DCR2025                        | LH                 | Refer to user manual                                     | S/P                        | 0.20-150.00 mIU/mL                                       | 100 µ L       | 15 min        |
| DCR2026                        | FSH                | Refer to user manual                                     | S/P                        | 0.20-150.00 mIU/mL                                       | 100 µL        | 15 min        |
| DCR2027                        | AMH                | Refer to user manual                                     | S/P                        | 0.10-20.00 ng/mL   | 100 µL        | 15 min        |
| DCR2028                        | PRL                | Refer to user manual                                     | S/P                        | 0.50-200.00 ng/mL  | 100 µL        | 15 min        |
| DCR2039                        | Prog               | Refer to user manual                                     | S/P                        | 0.10-40.00 ng/mL   | 100 µL        | 15 min        |